

LSS-505 Quick Start Guide

**(You can also watch our quick start guide video at:
<http://www.tivax.com/index.php/sewing-machine/lss-505.html>)**

1. Threading

When threading the sewing machine, make sure that the "power off/speed switch" is in the OFF position.

Turn the hand wheel counter-clockwise until the needle is in the highest position.

Follow the guides on the machine. These are marked from 1 to 6. Ensure that the pressure foot is in the UP position, so the thread can go in between the tension discs on the front of the machine. When threading the needle, the thread goes from the front to the back (see image #7 below).

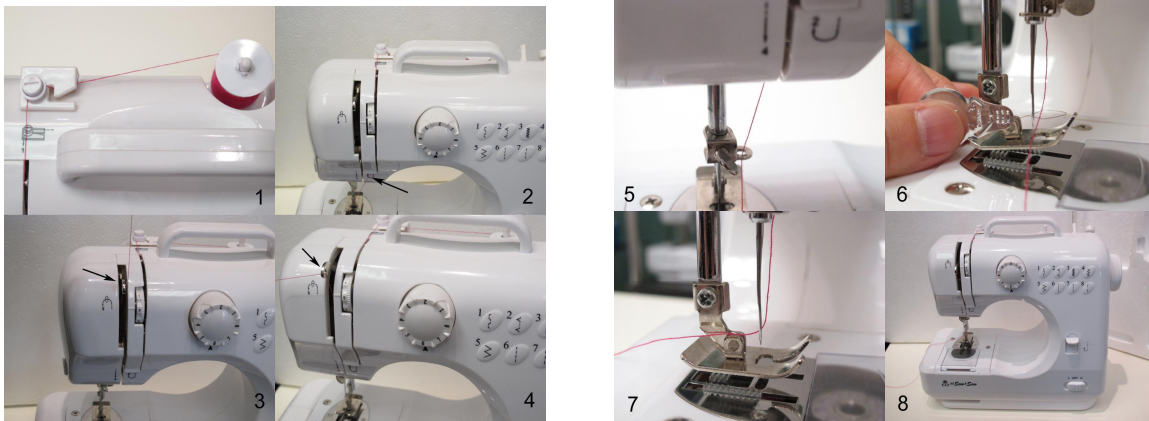

To initially pick up the bobbin thread, unwind 4 to 5 inches of bobbin thread and place the bobbin in the bobbin case. Hold needle thread loosely with your left hand. Slowly turn the hand wheel counter-clockwise towards yourself until the needle goes down and comes back up with the bobbin thread.

2. Rewinding the bobbin (refer to picture below)

Put a spool of thread on the spool pin. Wrap the thread around - to the right of the bobbin winder tension disk. Wind the thread clockwise around the bobbin several times. Put the bobbin onto the bobbin winder pin and push it to the left, towards the bobbin winder stop.



Turn on the speed switch to start winding.
Stop winding after the desired amount of thread is wound on the bobbin.
Take the bobbin off the spindle and cut the thread.

3. Needle replacement

Remove the batteries and/or disconnect the AC/DC adapter before starting to replace the needle.

- a. Turn the hand wheel to raise the needle to its highest position.
- b. Loosen the needle clamp screw. Remove the old needle.
- c. Insert the new needle into the clamp with the flat side toward the back of the machine. Push the needle up all the way into the needle bar.

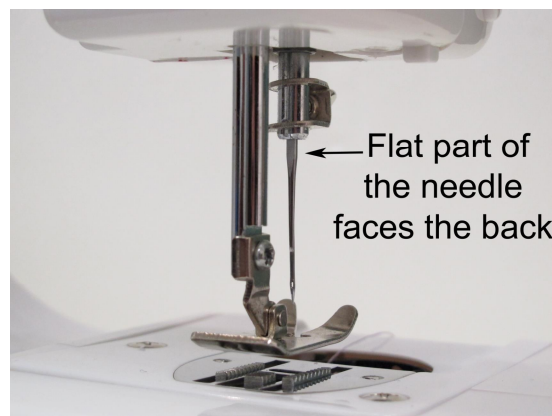

- d. Tighten the needle clamp screw.

4. Trouble shooting

Occasionally, the bobbin case may become loose and move freely within the throat of the machine. This can be remedied by removing the two screws holding the throat plate and repositioning the bobbin holder.

Raise the needle and presser foot. Take out the two screws and remove the cover. Align the bobbin holder with the back of the machine as shown in the picture below. The two tabs on the bottom of the throat plate cover keep it in place. Put back the plate and screws.

